

PARTICIPA EN LA ENCUESTA



SCAN HERE

www.surveymonkey.com/r/clr4ps



BE A PART OF
**RESULTS IN
THE ROCK**

BIENVENIDOS DISTRITO 2



BE A PART OF
**RESULTS IN
THE ROCK**

ENVÍE SUS PREGUNTAS



SCAN HERE



www.surveymonkey.com/r/clrtaxquestions

VISION GENERAL

Propuesta: Aumento del impuesto sobre las ventas de un centavo
Ingresos estimados en 10 años: Más de \$650 millones

Impacto: Transformaciones históricas en la calidad de vida y el entorno que unirán, desarrollarán y TRANSFORMARÁN Little Rock.

La propuesta actual refleja un impuesto del 5/8 por ciento para mejoras de capital que "caducaría" después de 10 años y un impuesto permanente del 3/8 por ciento para cubrir los costos de mantenimiento y operación a largo plazo.

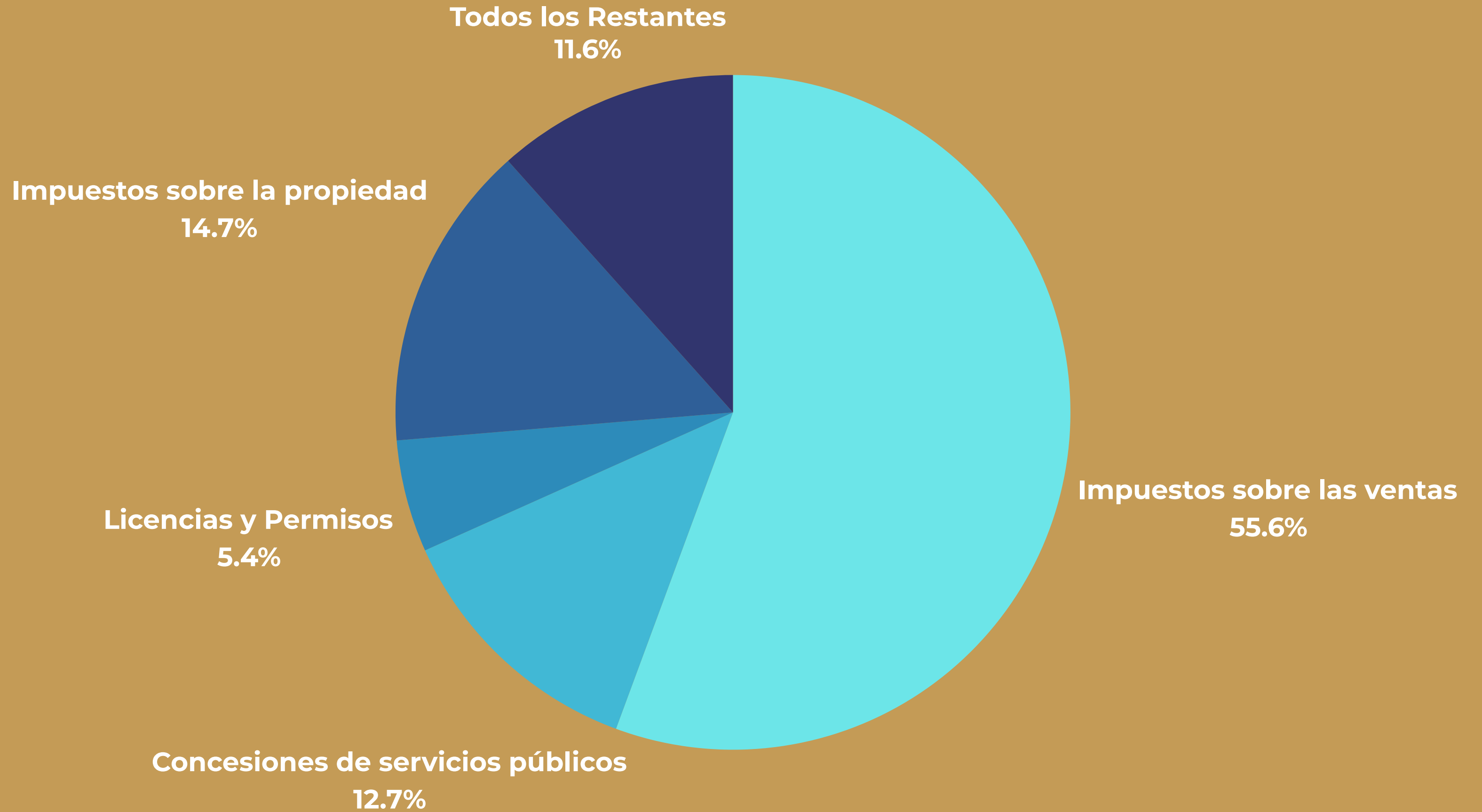

Presupuestos Del Fondo General - \$257,510,221

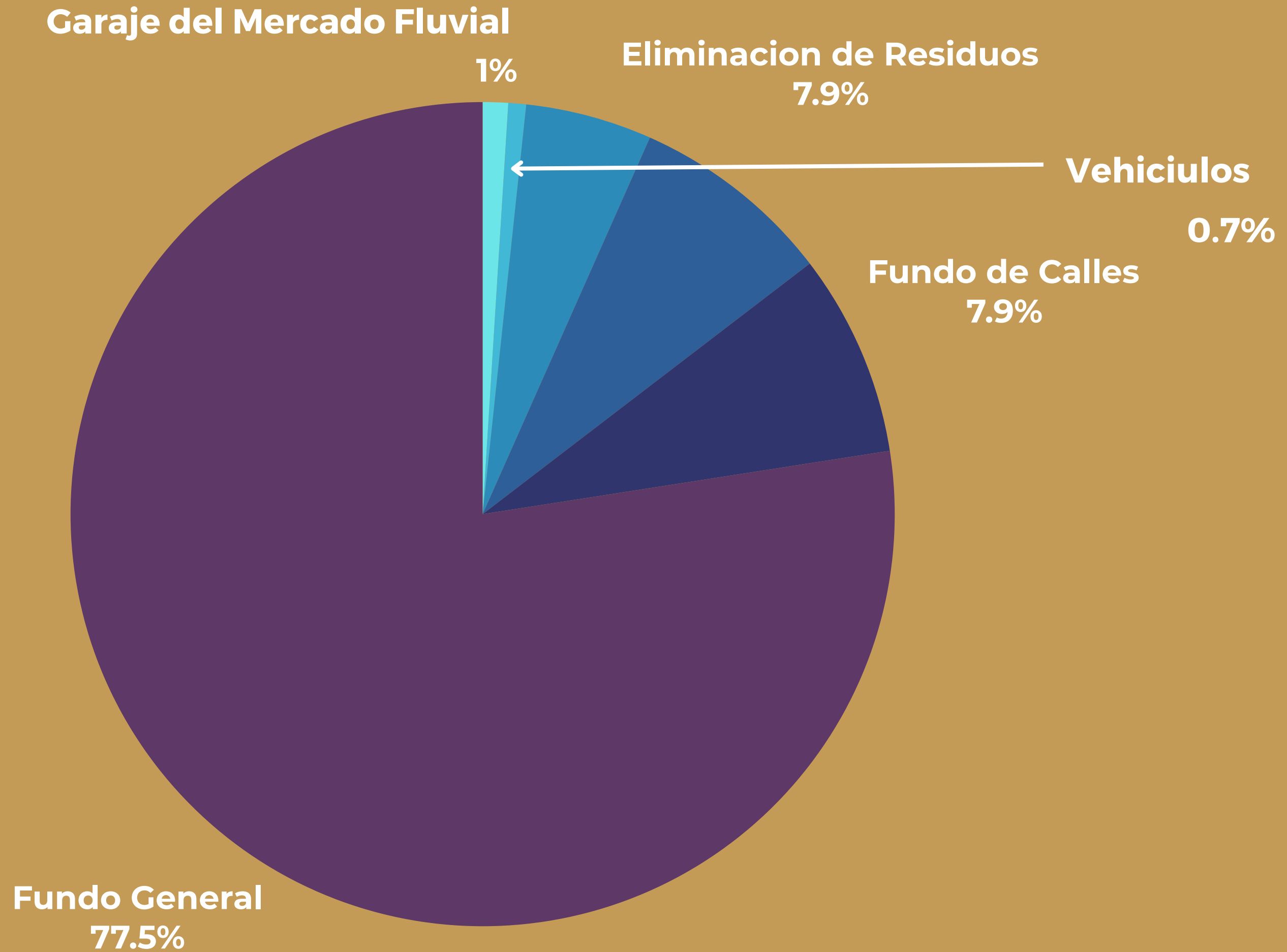

Presupuestos Total - \$330,622,668

Porcentaje de Impuesto Sobre las Ventas



Texarkana: 10.25%

Cabot: 10%

Pine Bluff: 10%

Bryant: 9.875%

Mountain Home: 9.875%

Fayetteville: 9.75%

Bentonville: 9.5%

Fort Smith: 9.5%

Hot Springs: 9.5%

North Little Rock: 9.5%

Conway: 9.125%

Little Rock: 8.625%

Jonesboro: 8.5%

Porcentaje de Impuesto Sobre las Ventas

Little Rock Sales tax : 8.625%

- State - 6.5%
- County - 1.0 %
- City - 1.125%



ARKANSAS

Impuesto Sobre Las Ventas Actual 8.625%

Porcentaje de Impuesto Sobre las Ventas

Chicago, IL : 10.25%

Birmingham, AL 10.0%

Memphis, TN : 9.75%

St. Louis, MO : 9.68%

Chattanooga, TN : 9.25%

Nashville, TN : 9.25%

Huntsville, AL : 9.0 %

Little Rock, AR : 8.625%



NUESTRA CIUDAD NUESTRO PROGRESO

Resultados a pesar de recursos limitados

**NUEVOS
EMPLEOS**

11,000

Delincuencia en
GENERAL

4%

INFRAESTRUCTURA

15,400FT

RENOVACIÓN
DE PAVIMENTO
PEATONAL

CUATRO FUNDAMENTOS

Gastos y distribuciones actuales



SEGURIDAD PUBLICA

- Vehículos
- Tecnología

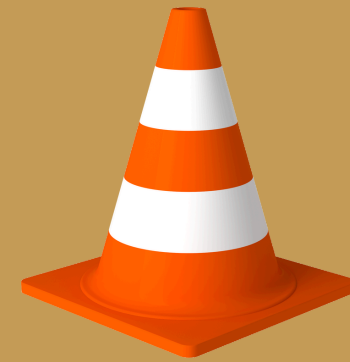

INFRAESTRUCTURA PUBLICA

- Drenaje
- Banquetas
- Carreteras pavimentadas



PARQUES Y RECREACIÓN

- Instalaciones deportivas
- Areas verdes mejoradas



PUERTOS Y DESARROLLO ECONOMICO

- Expansión
- Generar ingresos

La inversión de los 4 Fundamentos resulta en

PROGRESO ELEVADO



BE A PART OF

**RESULTS IN
THE ROCK**

SEGURIDAD PUBLICA

Departamento De Policia De Little Rock

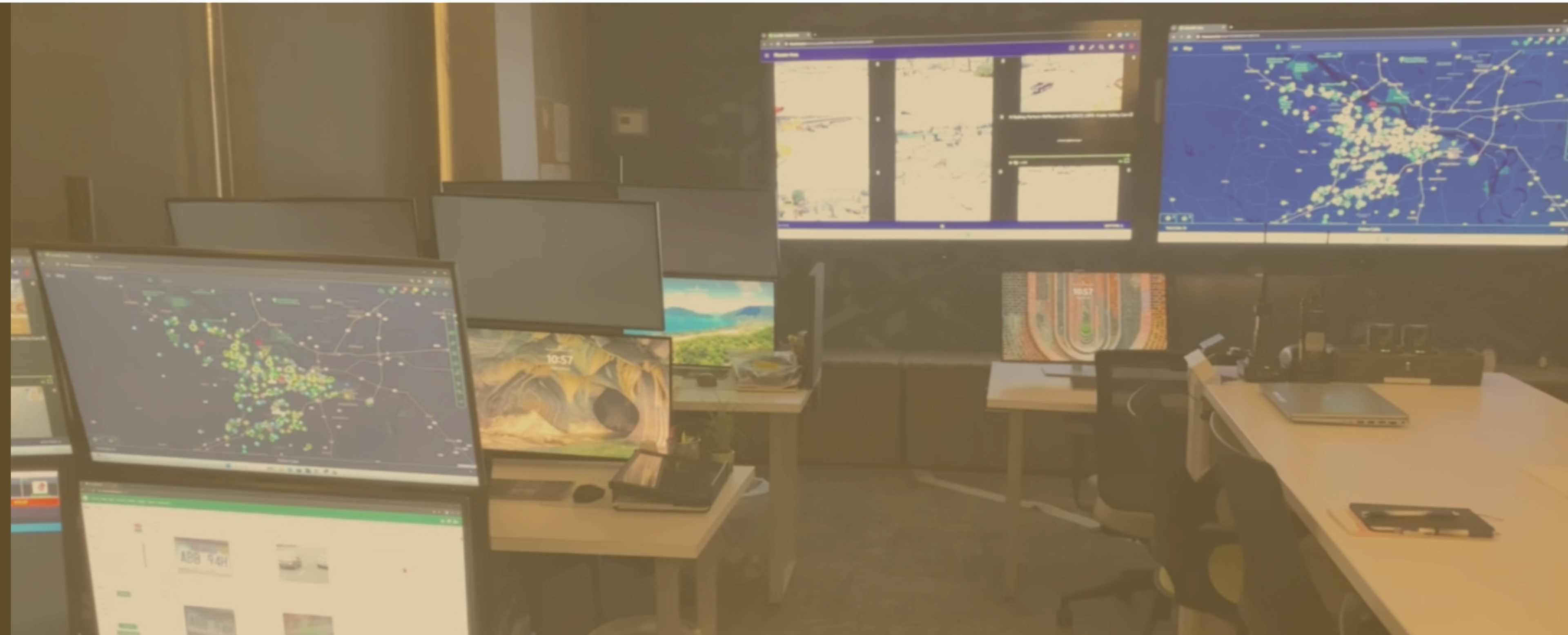

Sales Tax Project List

Capital vs. Operating

Snapshot of Proposed Projects

Description		Status	Capital Investment	Estimated Operating Expense Increase	Total Estimated Investment 1st 10 years	Estimated Average Annual Ongoing Allocation
Public Safety:						
1	WLR Fire Station Operations	Ongoing		\$ 8,000,000	\$ 8,000,000	\$ 800,000
2	Public Safety - Community Oriented Policing and Mental Health Response Teams	Ongoing		\$ 15,000,000	\$ 15,000,000	\$ 1,500,000
3	Public Safety Technology, Real-Time Crime Center & Field Operations	Ongoing		\$ 30,000,000	\$ 30,000,000	\$ 3,000,000
4	Public Safety and Code Enforcement Vehicle and Apparatus Replacement Including EVs	Ongoing		\$ 37,250,000	\$ 37,250,000	\$ 3,725,000
5	Fire Station Renovation Fund	New		\$ 5,000,000	\$ 5,000,000	\$ 500,000
6	Code Enforcement	New		\$ 5,000,000	\$ 5,000,000	\$ 500,000
7	Public Safety Total		\$ -	\$ 100,250,000	\$ 100,250,000	15%
8	Homelessness	New	\$ -	\$ 20,000,000	\$ 20,000,000	3%
9	Affordable Housing	New	\$ 10,000,000	\$ -	\$ 10,000,000	2%

SEGURIDAD PUBLICA

Departamento De Bomberos De Little Rock



Sales Tax Project List

Capital vs. Operating

Snapshot of Proposed Projects

Description	Status	Capital Investment	Estimated Operating Expense Increase	Total Estimated Investment 1st 10 years		Estimated Average Annual Ongoing Allocation
Public Safety:						
1 WLR Fire Station Operations	Ongoing		\$ 8,000,000	\$ 8,000,000		\$ 800,000
2 Public Safety - Community Oriented Policing and Mental Health Response Teams	Ongoing		\$ 15,000,000	\$ 15,000,000		\$ 1,500,000
3 Public Safety Technology, Real-Time Crime Center & Field Operations	Ongoing		\$ 30,000,000	\$ 30,000,000		\$ 3,000,000
4 Public Safety and Code Enforcement Vehicle and Apparatus Replacement Including EVs	Ongoing		\$ 37,250,000	\$ 37,250,000		\$ 3,725,000
5 Fire Station Renovation Fund	New		\$ 5,000,000	\$ 5,000,000		\$ 500,000
6 Code Enforcement	New		\$ 5,000,000	\$ 5,000,000		\$ 500,000
7 Public Safety Total		\$ -	\$ 100,250,000	\$ 100,250,000	15%	\$ 10,025,000
8 Homelessness	New	\$ -	\$ 20,000,000	\$ 20,000,000	3%	\$ 2,000,000
9 Affordable Housing	New	\$ 10,000,000	\$ -	\$ 10,000,000	2%	\$ -

INFRAESTRUCTURA PUBLICA

Mejoras en Infraestructura con Obras Públicas



CONSTRUCTION COSTS 2010 - 2023

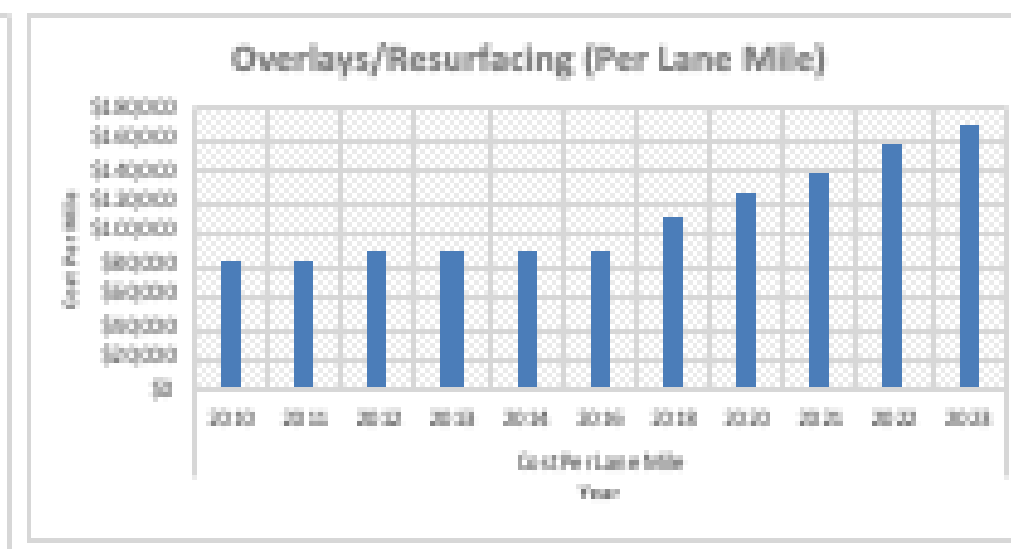
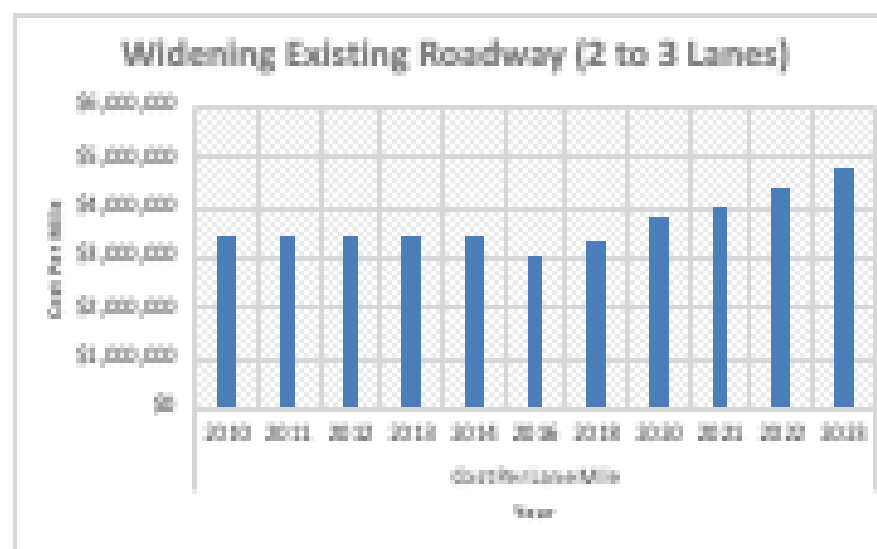
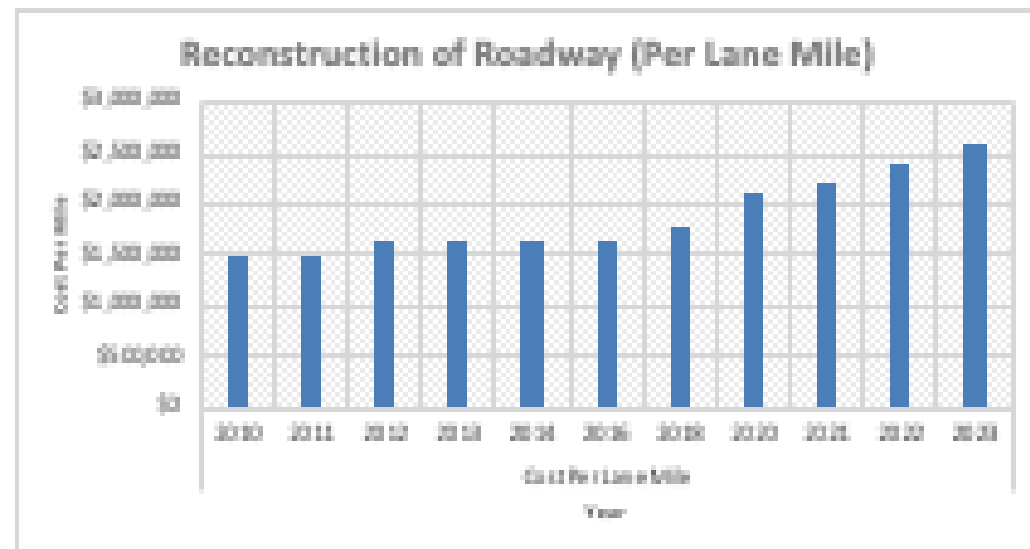
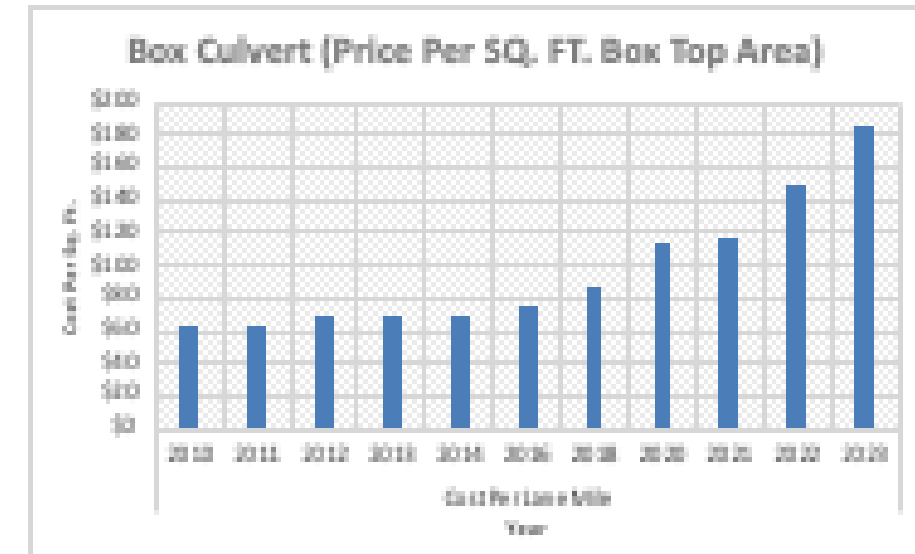
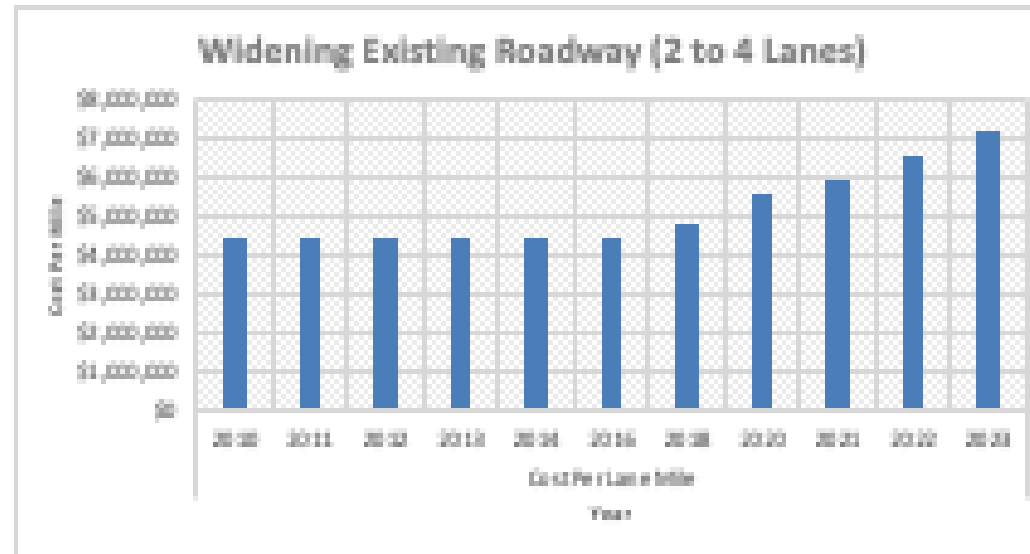
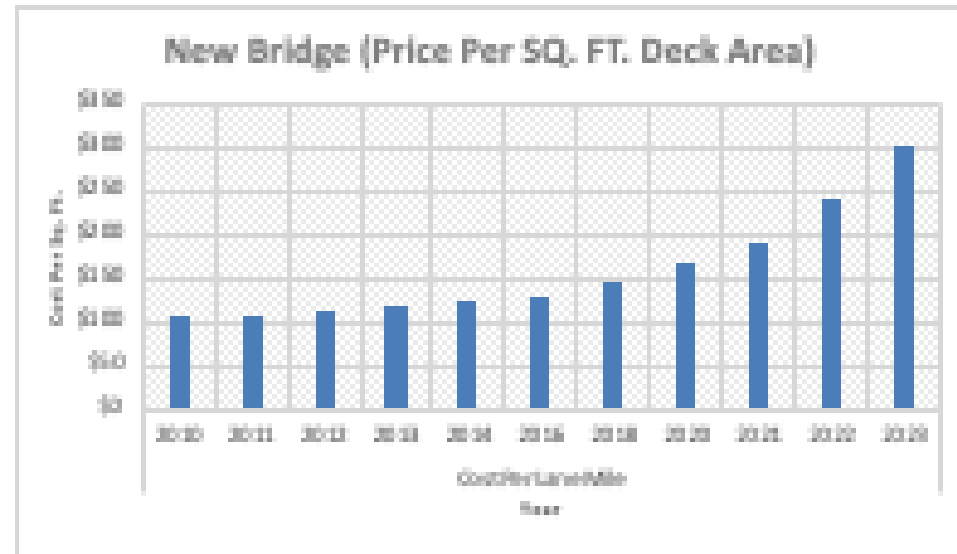

AVERAGE INCREASE IN ROADWAY CONSTRUCTION COSTS IN ARKANSAS FROM 2010 TO 2023 = 109%

Public Infrastructure:

28 Strategic Infrastructure Improvements	Ongoing	\$	80,000,000		\$	80,000,000		\$	-	
29 Targeted Community Development Infrastructure	Ongoing	\$	5,000,000		\$	5,000,000		\$	-	
30 Street Resurfacing, Sidewalks, and Infrastructure	Ongoing			\$	40,000,000	\$	40,000,000	\$	4,000,000	
31 Sustainable Infrastructure	New	\$	1,000,000			\$	1,000,000	\$	-	
32 Public Infrastructure Total		\$	86,000,000	\$	40,000,000	\$	126,000,000	19%	\$	4,000,000

PARQUES Y RECREACIÓN

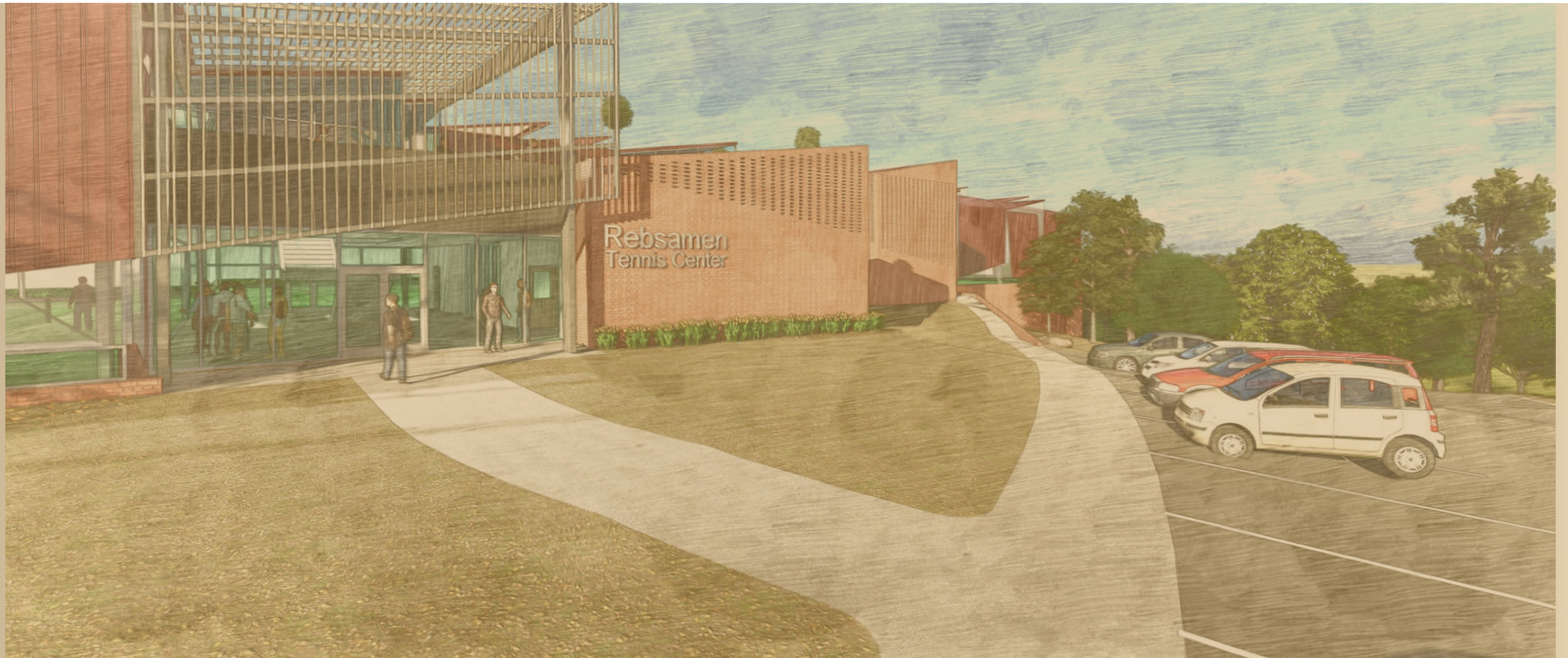

Parks and Quality of Life:

10	General Park Improvements & Maintenance	Ongoing	\$ 16,500,000	\$ 12,500,000	\$ 29,000,000	\$ 1,250,000
11	General Trail Improvements & Maintenance	Ongoing	\$ 5,000,000	\$ 3,500,000	\$ 8,500,000	\$ 350,000
12	Hindman Park (Improvements focused on Outdoor Recreation) - Southwest Little Rock	New	\$ 14,000,000	\$ 1,000,000	\$ 15,000,000	\$ 100,000
13	War Memorial Park (Central Destination Park)	New	\$ 14,000,000	\$ 1,000,000	\$ 15,000,000	\$ 100,000
14	Indoor Sports Complex (10 Multi-Purpose Courts) - Downtown Little Rock	New	\$ 60,000,000	\$ 4,000,000	\$ 64,000,000	\$ 400,000
15	Outdoor Sports Complex (Multi-Purpose Fields) - West Little Rock	New	\$ 60,000,000	\$ 4,000,000	\$ 64,000,000	\$ 400,000
16	West Central Complex / Outdoor Pool	New	\$ 8,000,000	\$ 2,000,000	\$ 10,000,000	\$ 200,000
17	Senior Center and Pickleball	New	\$ 3,000,000	\$ 2,000,000	\$ 5,000,000	\$ 200,000
18	Murray/Rebsamen Park Soccer	New	\$ 1,500,000		\$ 1,500,000	\$ -
19	Jim Dailey Fitness and Aquatics Center	Ongoing	\$ 3,000,000	\$ 1,000,000	\$ 4,000,000	\$ 100,000
20	15 Acre Park - Downtown	New	\$ 10,000,000		\$ 10,000,000	\$ -
21	1st Tee Golf Expansion and Rebranding	New	\$ 3,000,000	\$ 1,250,000	\$ 4,250,000	\$ 125,000
22	Rebsamen Golf Pro Shop and Renovations	New	\$ 10,000,000	\$ 4,000,000	\$ 14,000,000	\$ 400,000
23	Community Center Investment	Ongoing	\$ 8,000,000	\$ 2,000,000	\$ 10,000,000	\$ 200,000
24	Rebsamen Tennis Center Indoor Complex	New	\$ 8,000,000	\$ 1,500,000	\$ 9,500,000	\$ 150,000
25	Zoo Master Plan Implementation	New	\$ 30,000,000		\$ 30,000,000	\$ -
26	Zoo Net Operations Increase	Ongoing		\$ 10,000,000	\$ 10,000,000	\$ 1,000,000
27	Parks and Quality of Life Total		\$ 254,000,000	\$ 49,750,000	\$ 303,750,000	47% \$ 4,975,000

LITTLE ROCK ZOO



LITTLE ROCK ZOO

LITTLE ROCK ZOO

Master Plan Implementation

- Update/Upgrade Outdated Facilities
- Improve Back of the House Inefficiencies
- Tourism Economic Impact



PUERTOS Y DESARROLLO ECONÓMICO



Port Expansion and Economic Development:

33	Economic Development Impact Fund	New	\$	22,000,000		\$	22,000,000		\$	-	
34	Little Rock Port Infrastructure and Expansion	New	\$	8,000,000		\$	8,000,000		\$	-	
35	Port Expansion and Economic Development Total		\$	30,000,000	\$	-	\$	30,000,000	5%	\$	-
36	Information Technology	Ongoing			\$	12,250,000	\$	12,250,000	2%	\$	1,225,000

DISCUSIÓN

BE A PART OF

RESULTS IN
THE ROCK

ENVÍE SUS PREGUNTAS



SCAN HERE



www.surveymonkey.com/r/clrtaxquestions

COMPLETA LA ENCUESTA

BE A PART OF

RESULTS IN
THE ROCK



SCAN HERE

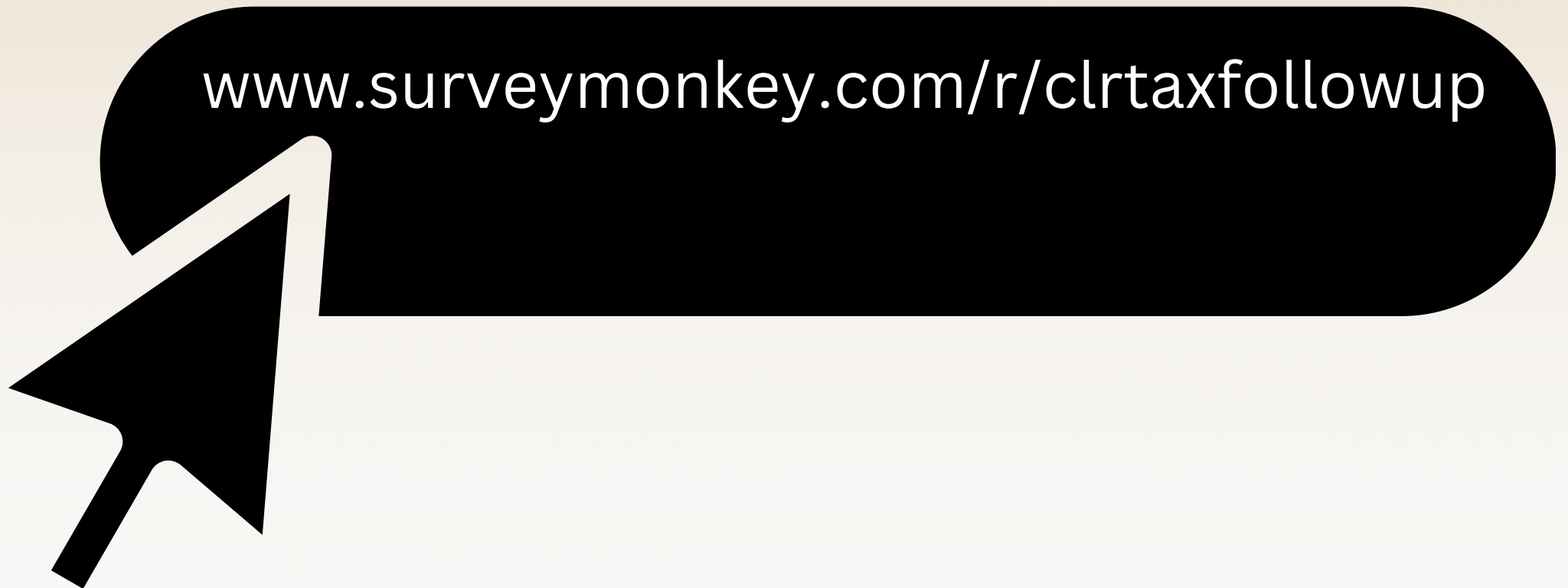

www.surveymonkey.com/r/clrtaxfollowup



GRACIAS