

# TAKE THE POLL



SCAN HERE

[www.surveymonkey.com/r/clr4ps](http://www.surveymonkey.com/r/clr4ps)



BE A PART OF  
**RESULTS IN  
THE ROCK**

# SUBMIT YOUR QUESTIONS



SCAN HERE



[www.surveymonkey.com/r/clrtaxquestions](http://www.surveymonkey.com/r/clrtaxquestions)

# OVERVIEW

**Proposal: One Cent Sales Tax Increase**  
**Estimated Revenue over 10 years: \$650+ million**

**Impact: historic improvements to quality of life and place  
that will unite, grow and TRANSFORM Little Rock**

**Current proposal reflects 5/8ths-percent tax for capital improvements  
that would "sunset," after 10 years and a permanent, 3/8th-cent tax to  
cover long-term maintenance and operational costs.**

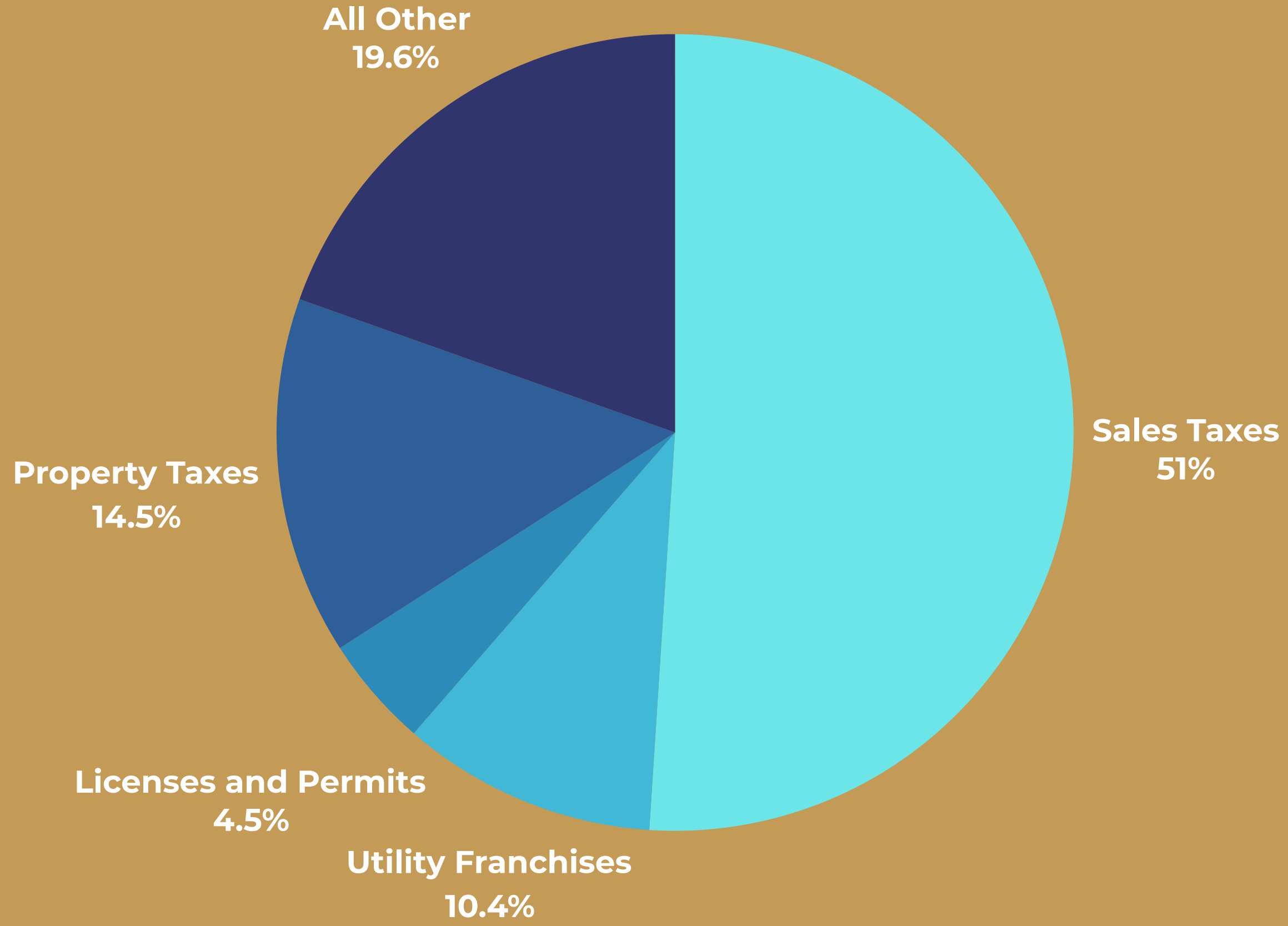

# Sources of Revenue

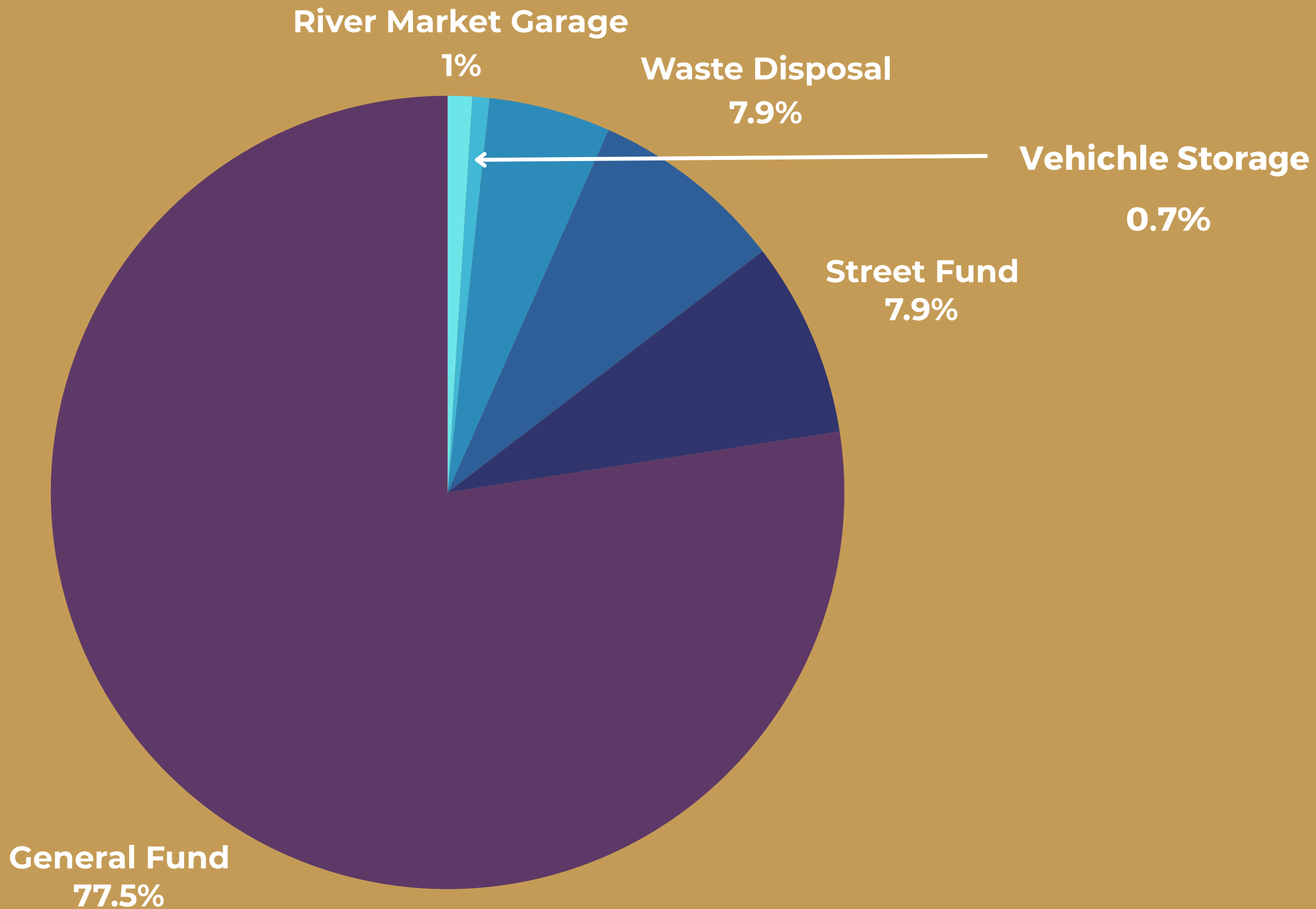

**Total Budget - \$330,622,668**



# Sales Tax Rates

Texarkana: 10.25%

Cabot: 10%

Pine Bluff: 10%

Bryant: 9.875%

Mountain Home: 9.875%

Fayetteville: 9.75%

Bentonville: 9.5%

Fort Smith: 9.5%

Hot Springs: 9.5%

North Little Rock: 9.5%

Conway: 9.125%

**Little Rock: 8.625%**

Jonesboro: 8.5%



# Sales Tax Rates

## Little Rock Sales Tax : 8.625%

- State : 6.5%
- County : 1.0 %
- City : 1.125%

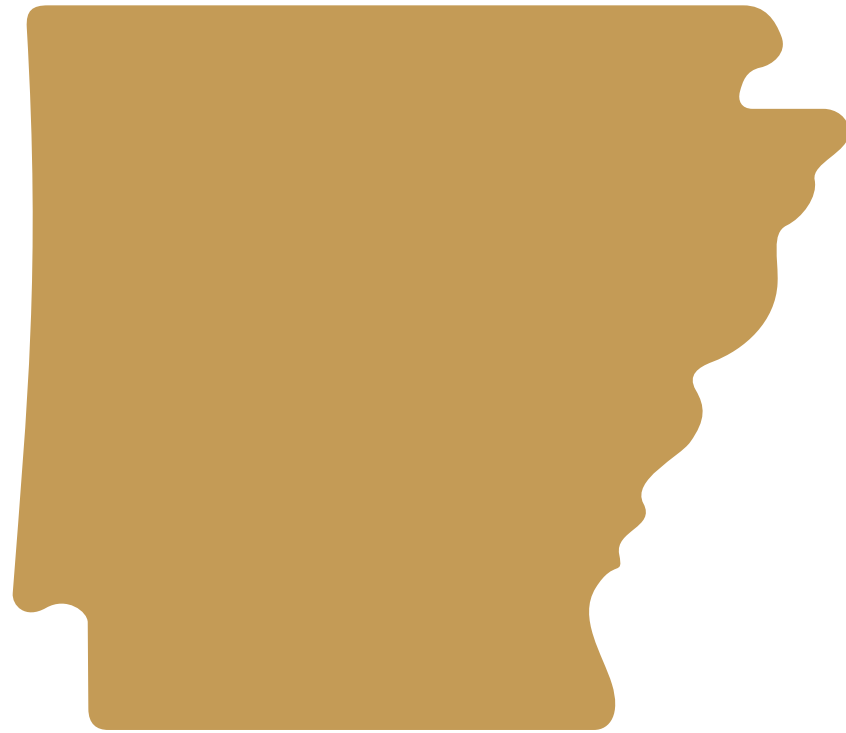

# Sales Tax Rates

Chicago, IL : 10.25%

Birmingham, AL 10.0%

Memphis, TN : 9.75%

St. Louis, MO : 9.68%

Chattanooga, TN : 9.25%

Nashville, TN : 9.25%

Huntsville, AL : 9.0 %

**Little Rock, AR : 8.625%**



# OUR CITY OUR PROGRESS

Results despite limited resources

**NEW JOBS**

**11,000**

**OVERALL  
CRIME**

**4%**

**INFRASTRUCTURE**

**15,400FT  
OF SIDEWALK  
REPLACED**

# FOUR PILLARS

## Proposed expenditures and allocations



### PUBLIC SAFETY

- Fleet
- Technology
- 911 Emergency  
Communitaon

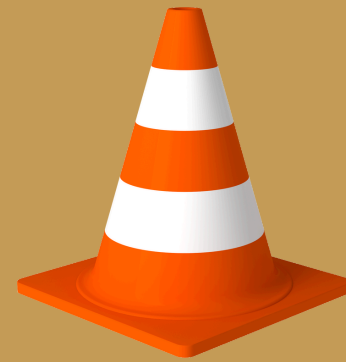

### PUBLIC INFRASTRUCTURE

- Drainage
- Sidewalks
- Resurfaced roads



### PARKS & RECREATION

- Sports Complexes
- Enhanced green space
- Trails
- Golf Courses
- Senior amenities
- Community Centers



### PORT & ECONOMIC DEVELOPMENT

- Expansion
- Generate revenue

Investment in the 4 Pillars results in  
**ELEVATED PROGRESS**



BE A PART OF  
**RESULTS IN  
THE ROCK**

# PUBLIC SAFETY

Little Rock Police Department

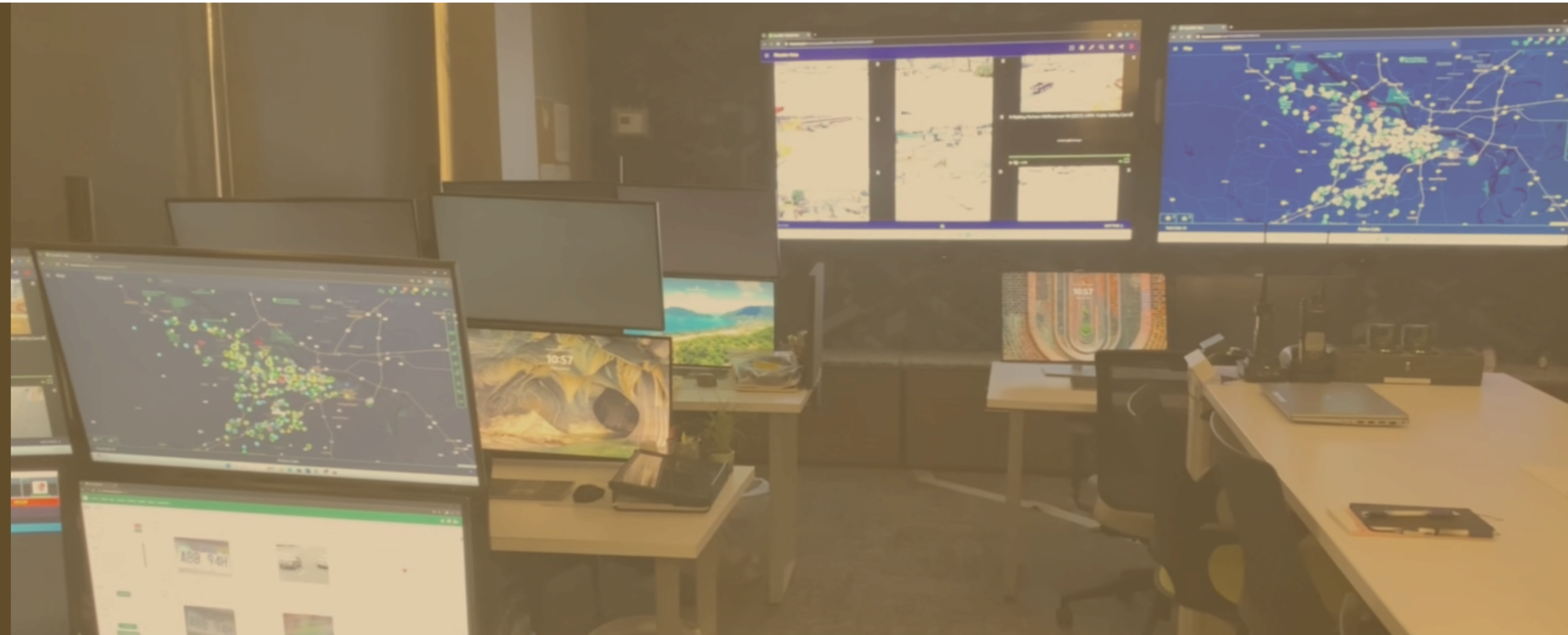

## Sales Tax Project List

Capital vs. Operating

Snapshot of Proposed Projects

Description	Status	Capital Investment	Estimated Operating Expense Increase	Total Estimated Investment 1st 10 years	Estimated Average Annual Ongoing Allocation
<b>Public Safety:</b>					
1 WLR Fire Station Operations	Ongoing		\$ 8,000,000	\$ 8,000,000	\$ 800,000
2 Public Safety - Community Oriented Policing and Mental Health Response Teams	Ongoing		\$ 15,000,000	\$ 15,000,000	\$ 1,500,000
3 Public Safety Technology, Real-Time Crime Center & Field Operations	Ongoing		\$ 30,000,000	\$ 30,000,000	\$ 3,000,000
4 Public Safety and Code Enforcement Vehicle and Apparatus Replacement Including EVs	Ongoing		\$ 37,250,000	\$ 37,250,000	\$ 3,725,000
5 Fire Station Renovation Fund	New		\$ 5,000,000	\$ 5,000,000	\$ 500,000
6 Code Enforcement	New		\$ 5,000,000	\$ 5,000,000	\$ 500,000
<b>7 Public Safety Total</b>		<b>\$ -</b>	<b>\$ 100,250,000</b>	<b>\$ 100,250,000</b>	<b>15%</b> <b>\$ 10,025,000</b>
<b>8 Homelessness</b>	New	<b>\$ -</b>	<b>\$ 20,000,000</b>	<b>\$ 20,000,000</b>	<b>3%</b> <b>\$ 2,000,000</b>
<b>9 Affordable Housing</b>	New	<b>\$ 10,000,000</b>	<b>\$ -</b>	<b>\$ 10,000,000</b>	<b>2%</b> <b>\$ -</b>

# PUBLIC SAFETY

## Little Rock Fire Department



**Sales Tax Project List**  
 Capital vs. Operating  
 Snapshot of Proposed Projects

<b>Description</b>	<b>Status</b>	<b>Capital Investment</b>	<b>Estimated Operating Expense Increase</b>	<b>Total Estimated Investment 1st 10 years</b>	<b>Estimated Average Annual Ongoing Allocation</b>
<b>Public Safety:</b>					
1 WLR Fire Station Operations	Ongoing		\$ 8,000,000	\$ 8,000,000	\$ 800,000
2 Public Safety - Community Oriented Policing and Mental Health Response Teams	Ongoing		\$ 15,000,000	\$ 15,000,000	\$ 1,500,000
3 Public Safety Technology, Real-Time Crime Center & Field Operations	Ongoing		\$ 30,000,000	\$ 30,000,000	\$ 3,000,000
4 Public Safety and Code Enforcement Vehicle and Apparatus Replacement Including EVs	Ongoing		\$ 37,250,000	\$ 37,250,000	\$ 3,725,000
5 Fire Station Renovation Fund	New		\$ 5,000,000	\$ 5,000,000	\$ 500,000
6 Code Enforcement	New		\$ 5,000,000	\$ 5,000,000	\$ 500,000
<b>7 Public Safety Total</b>		<b>\$ -</b>	<b>\$ 100,250,000</b>	<b>\$ 100,250,000</b>	<b>15% \$ 10,025,000</b>
<b>8 Homelessness</b>	New	<b>\$ -</b>	<b>\$ 20,000,000</b>	<b>\$ 20,000,000</b>	<b>3% \$ 2,000,000</b>
<b>9 Affordable Housing</b>	New	<b>\$ 10,000,000</b>	<b>\$ -</b>	<b>\$ 10,000,000</b>	<b>2% \$ -</b>

# PUBLIC INFRASTRUCTURE

Capital Improvements with Public Works





# CONSTRUCTION COSTS 2010 - 2023

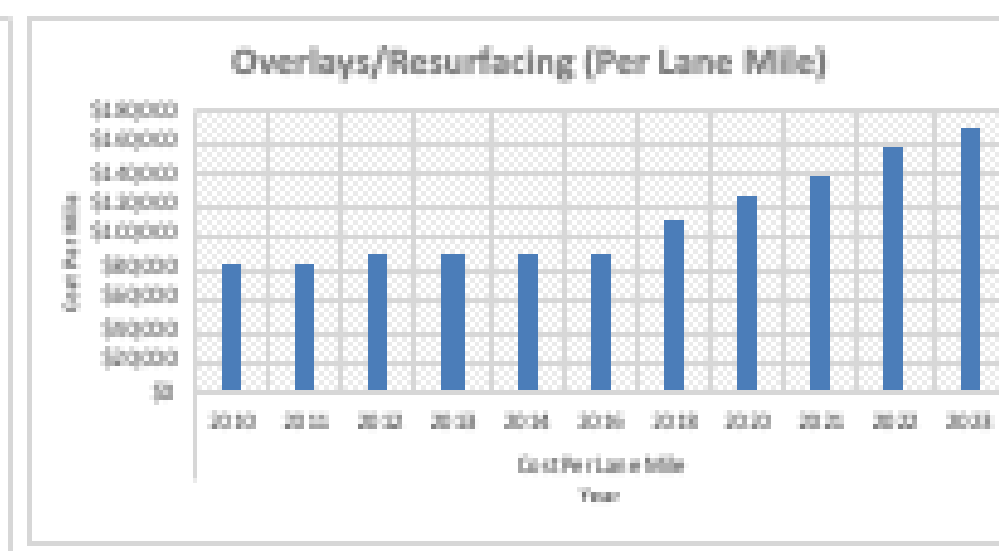
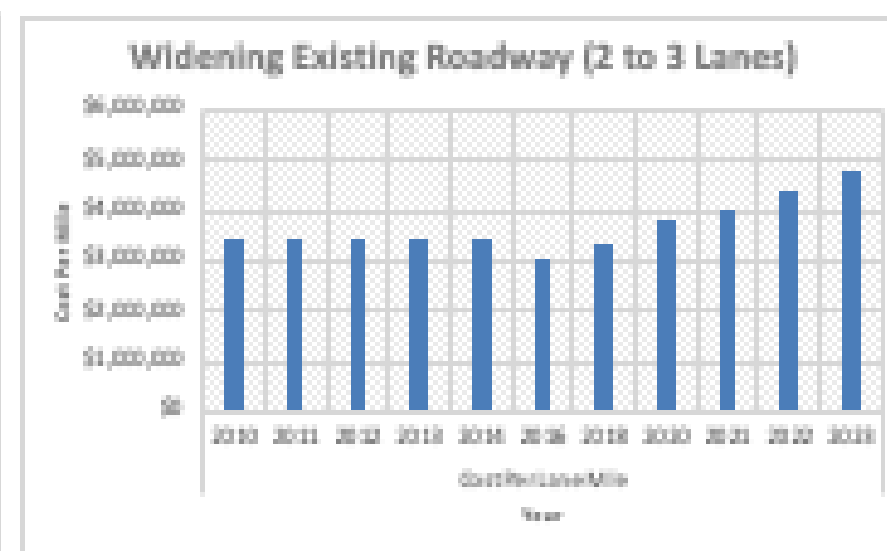
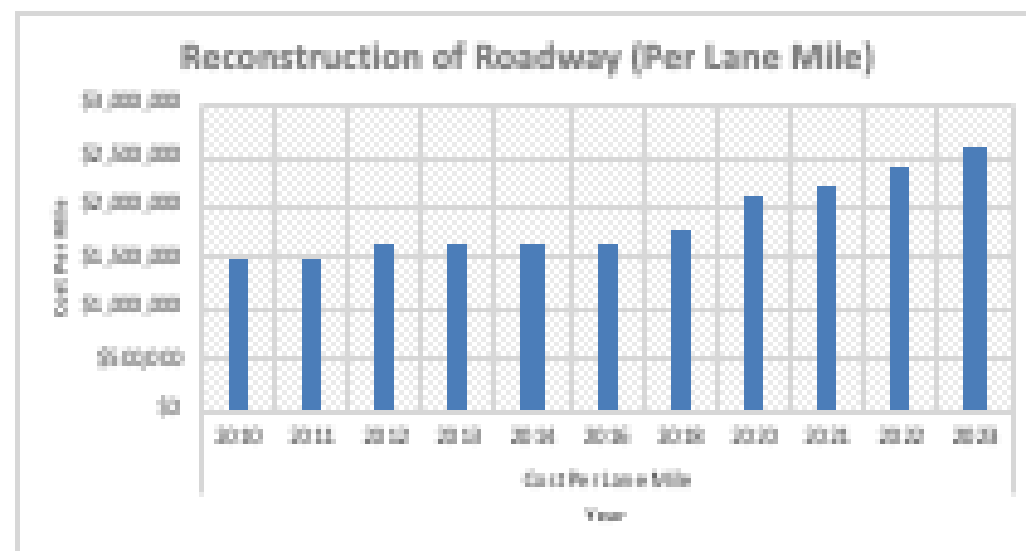
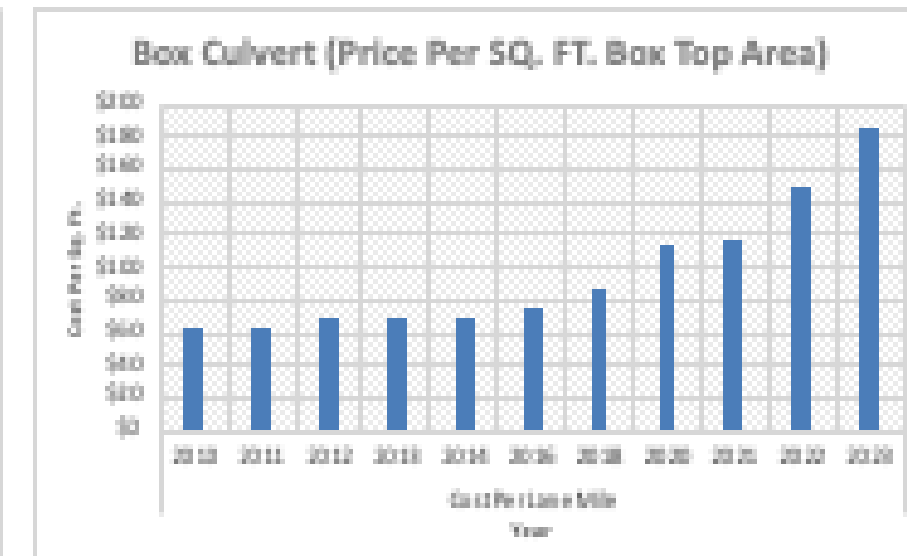
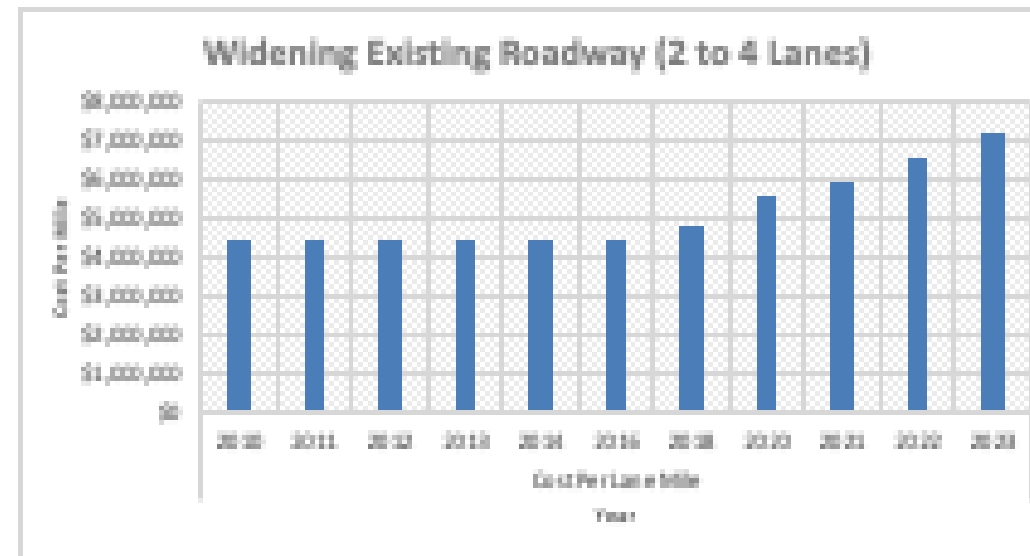
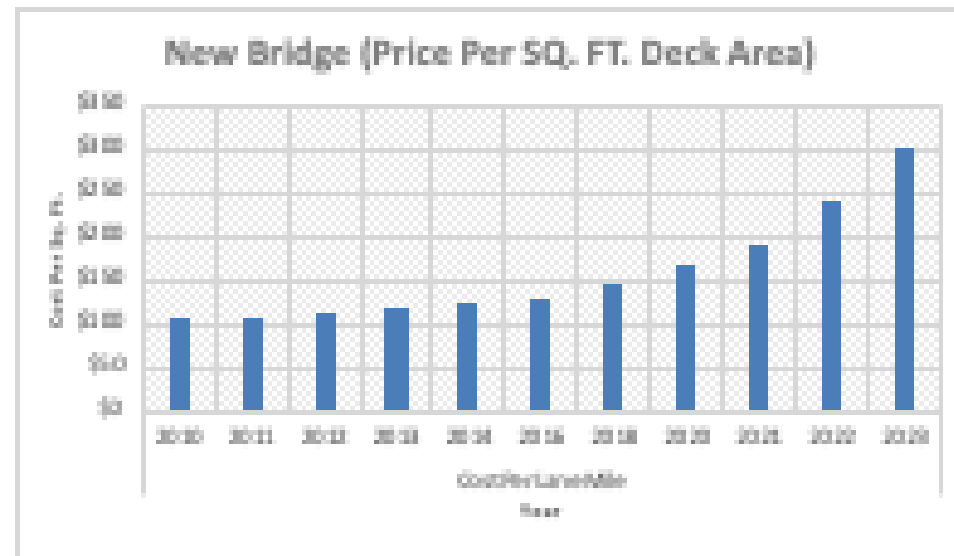

**AVERAGE INCREASE IN ROADWAY CONSTRUCTION COSTS IN ARKANSAS FROM 2010 TO 2023 = 109%**

**Public Infrastructure:**

28 Strategic Infrastructure Improvements	Ongoing	\$	80,000,000		\$	80,000,000	\$	-		
29 Targeted Community Development Infrastructure	Ongoing	\$	5,000,000		\$	5,000,000	\$	-		
30 Street Resurfacing, Sidewalks, and Infrastructure	Ongoing			\$	40,000,000	\$	40,000,000	\$	4,000,000	
31 Sustainable Infrastructure	New	\$	1,000,000		\$	1,000,000	\$	-		
<b>32 Public Infrastructure Total</b>		<b>\$</b>	<b>86,000,000</b>	<b>\$</b>	<b>40,000,000</b>	<b>\$</b>	<b>126,000,000</b>	<b>19%</b>	<b>\$</b>	<b>4,000,000</b>

# PARKS & RECREATION

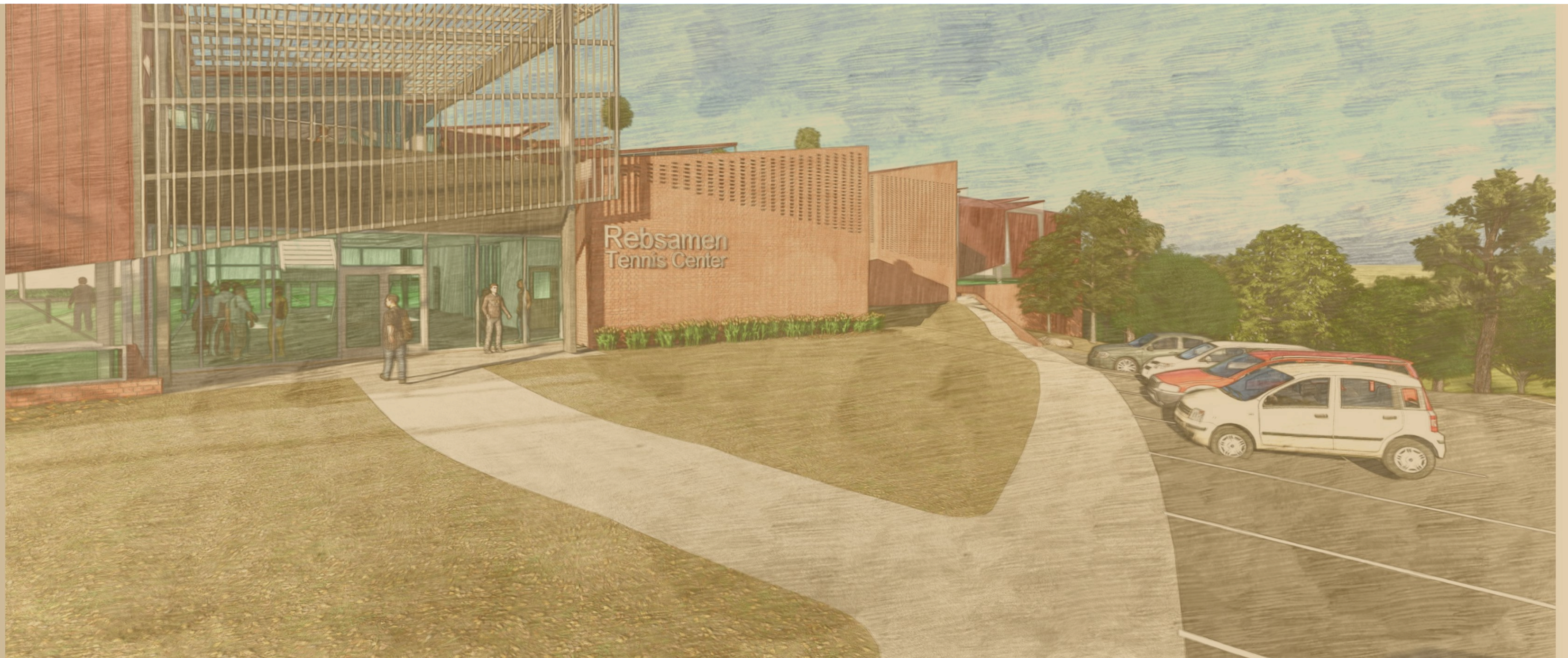

**Parks and Quality of Life:**

10	General Park Improvements & Maintenance	Ongoing	\$ 16,500,000	\$ 12,500,000	\$ 29,000,000	\$ 1,250,000	
11	General Trail Improvements & Maintenance	Ongoing	\$ 5,000,000	\$ 3,500,000	\$ 8,500,000	\$ 350,000	
12	Hindman Park (Improvements focused on Outdoor Recreation) - Southwest Little Rock	New	\$ 14,000,000	\$ 1,000,000	\$ 15,000,000	\$ 100,000	
13	War Memorial Park (Central Destination Park)	New	\$ 14,000,000	\$ 1,000,000	\$ 15,000,000	\$ 100,000	
14	Indoor Sports Complex (10 Multi-Purpose Courts) - Downtown Little Rock	New	\$ 60,000,000	\$ 4,000,000	\$ 64,000,000	\$ 400,000	
15	Outdoor Sports Complex (Multi-Purpose Fields) - West Little Rock	New	\$ 60,000,000	\$ 4,000,000	\$ 64,000,000	\$ 400,000	
16	West Central Complex / Outdoor Pool	New	\$ 8,000,000	\$ 2,000,000	\$ 10,000,000	\$ 200,000	
17	Senior Center and Pickleball	New	\$ 3,000,000	\$ 2,000,000	\$ 5,000,000	\$ 200,000	
18	Murray/Rebsamen Park Soccer	New	\$ 1,500,000		\$ 1,500,000	\$ -	
19	Jim Dailey Fitness and Aquatics Center	Ongoing	\$ 3,000,000	\$ 1,000,000	\$ 4,000,000	\$ 100,000	
20	15 Acre Park - Downtown	New	\$ 10,000,000		\$ 10,000,000	\$ -	
21	1st Tee Golf Expansion and Rebranding	New	\$ 3,000,000	\$ 1,250,000	\$ 4,250,000	\$ 125,000	
22	Rebsamen Golf Pro Shop and Renovations	New	\$ 10,000,000	\$ 4,000,000	\$ 14,000,000	\$ 400,000	
23	Community Center Investment	Ongoing	\$ 8,000,000	\$ 2,000,000	\$ 10,000,000	\$ 200,000	
24	Rebsamen Tennis Center Indoor Complex	New	\$ 8,000,000	\$ 1,500,000	\$ 9,500,000	\$ 150,000	
25	Zoo Master Plan Implementation	New	\$ 30,000,000		\$ 30,000,000	\$ -	
26	Zoo Net Operations Increase	Ongoing		\$ 10,000,000	\$ 10,000,000	\$ 1,000,000	
<b>27</b>	<b>Parks and Quality of Life Total</b>		<b>\$ 254,000,000</b>	<b>\$ 49,750,000</b>	<b>\$ 303,750,000</b>	<b>47%</b>	<b>\$ 4,975,000</b>

# LITTLE ROCK ZOO



LITTLE ROCK ZOO

# LITTLE ROCK ZOO

## Master Plan Implementation

- Update/Upgrade Outdated Facilities
- Improve Back of the House Inefficiencies
- Tourism Economic Impact



# PORT & ECONOMIC DEVELOPMENT



**Port Expansion and Economic Development:**

33	Economic Development Impact Fund	New	\$	22,000,000		\$	22,000,000		\$	-	
34	Little Rock Port Infrastructure and Expansion	New	\$	8,000,000		\$	8,000,000		\$	-	
<b>35</b>	<b>Port Expansion and Economic Development Total</b>		<b>\$</b>	<b>30,000,000</b>	<b>\$</b>	<b>-</b>	<b>\$</b>	<b>30,000,000</b>	<b>5%</b>	<b>\$</b>	<b>-</b>
<b>36</b>	<b>Information Technology</b>	Ongoing			<b>\$</b>	<b>12,250,000</b>	<b>\$</b>	<b>12,250,000</b>	<b>2%</b>	<b>\$</b>	<b>1,225,000</b>



# DISCUSSION

BE A PART OF

RESULTS IN  
THE ROCK

# SUBMIT YOUR QUESTIONS



SCAN HERE



[www.surveymonkey.com/r/clrtaxquestions](http://www.surveymonkey.com/r/clrtaxquestions)

# COMPLETE THE SURVEY

BE A PART OF

RESULTS IN  
THE ROCK



**SCAN HERE**



[www.surveymonkey.com/r/clrtaxfollowup](http://www.surveymonkey.com/r/clrtaxfollowup)



**THANK YOU**